



# FF880 freestanding full height freezer

Manual for Installation, Use and Maintenance

|C|D|A|

## Important

The CDA Group Ltd cannot be held responsible for injuries or losses caused by incorrect use or installation of this product. Please note that CDA reserve the right to invalidate the guarantee supplied with this product following incorrect installation or misuse of the appliance.

This appliance is not designed to be used by people (including children) with reduced physical, sensorial or mental capacity, or who lack experience or knowledge about it, unless they have had supervision or instructions on how to use the appliance by someone who is responsible for their safety.

Under no circumstances should any external covers be removed for servicing or maintenance except by suitably qualified personnel.

### Appliance information:

Please enter the details on the appliance rating plate below for reference, to assist CDA Customer Care in the event of a fault with your appliance and to register your appliance for guarantee purposes.

Appliance Model

Serial Number

### CE Declarations of Conformity:


This appliance has been designed, constructed and marketed in compliance with safety requirements of EEC Directive 2006/95/EEC (Low voltage) and requirements of EMC Directive 2004/108/EEC.

This appliance has been manufactured to the strictest standards and complies with all applicable legislation, including Electrical safety (LVD) and Electromagnetic interference compatibility (EMC). Parts intended to come into contact with food conform to EEC/89/109.4

### IMPORTANT INFORMATION FOR CORRECT DISPOSAL OF THE PRODUCT IN ACCORDANCE WITH EC DIRECTIVE 2002/96/EC.

At the end of its working life, the product must not be disposed of as urban waste. The refrigeration system contains insulating gases and refrigerants, which require specialised waste disposal. The valuable materials contained in this appliance can be recycled. It must be taken to a special local authority differentiated waste collection centre or to a dealer providing this service.

Before disposing of an old appliance, remove the latch or bolt lock to avoid the risk of child entrapment.

Disposing of a household appliance separately avoids possible negative consequences for the environment and health deriving from inappropriate disposal and enables the constituent materials to be recovered to obtain significant savings in energy and resources. As a reminder of the need to dispose of household appliances separately, the product is marked with a crossed-out wheeled dustbin. 

## Before First Use

You must allow the freezer to settle for at least twenty four hours prior to switching the power on.

It is recommended that you clean the interior of the appliance prior to first use, using a solution of bicarbonate of soda and warm water and then thoroughly drying the interior.

The freezer may have an odour to it at first use. This will disappear as the appliance cools.

Do not load the freezer with food until the freezer reaches the required temperature

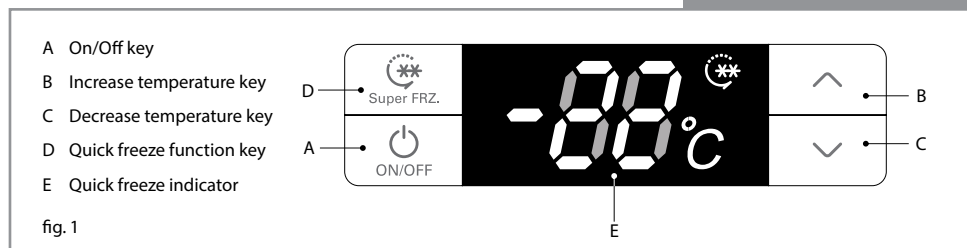
Please note:

- The appliance will work continuously until it comes down to the correct temperature.
- If the appliance is switched off, you should allow five minutes before switching it on again to prevent unnecessary damage to the compressor.

Use

- Do not use electrical devices inside the freezer.
- Do not damage the refrigerant circuit.
- Do not use flammable solvents near the appliance.
- Do not place heavy items on top of the freezer.
- Never store inflammable or explosive items and strong corrosive acids or alkalis in the appliance.
- This is a household appliance, which is produced in accordance with the national standard. It is intended for food storage only, not for storage of blood, medicine and biological products.
- To prevent risk of fire, keep the appliance away from petrol or any other inflammables.
- To prevent risk of electromagnetic interference or other accidents, do not place a microwave oven on top of the freezer or use any electric appliance inside the freezer.
- Do not allow children to play with or near the appliance.
- The internal surface of the freezer compartment is very cold when the appliance is running. Do not touch the surface especially when hands are wet.
- Do not splash water onto the appliance. Keep it away from places of high humidity that may have adverse effect on the electric insulation performance.
- This appliance is designed to be used in ambient temperatures between 10 and 43°C. Use outside of this range may cause the appliance to fail.
- Never put liquids in the freezer uncovered.
- Never put hot foods in the freezer. Cool warm food to room temperature before being put into the freezer.
- The freezer compartments are designed to store only frozen food
- Follow the instructions on the packaging for storage of frozen food. If not information is provided, foods should not be stored for more than three months after the purchase date.
- Never put carbonated drinks into the freezer as the carbon dioxide may expand causing an explosion.

## Control Panel



### Switching the freezer on and off

To switch on the freezer for the first time, press and hold the On/Off key (A) for three seconds. The freezer will beep twice, and will run at the factory preset temperature of  $-18^{\circ}$ . To switch the freezer off, press and hold the On/Off key for three seconds.

### Setting the temperature

Press the increase or decrease temperature keys (B & C) to select the required temperature between  $-16^{\circ}$  and  $-24^{\circ}$ . Once the required temperature is shown on the display, the temperature will set after five seconds' delay and the freezer will beep twice to confirm the setting.

The freezer will take some time to adjust to the new settings. This will depend on the difference between the old and new settings, the ambient temperature, the amount of food in the freezer and the number of times the door is opened.

### Over temperature alarm

The freezer is equipped with an over temperature alarm to warn when the temperature in the freezer has been over  $-8^{\circ}$  for six hours or more. The fridge will beep ten times every thirty minutes until the freezer temperature is below  $-12^{\circ}$ , and the fault code E9 will show on the display. Press any key to switch the alarm off. E9 will continue to show on the display until the fault is resolved.



### Super freeze function

The super freeze function can be used to freeze large quantities of fresh food as quickly as possible. This function can be set for specific durations before switching off automatically for convenience.

To switch on the super freeze function, touch and hold the super freeze function key (D) for approximately three seconds. The super freeze symbol on the display will flash and the freezer temperature display will show 6. Touch the increase or decrease keys to select the duration for the super freeze function (6, 12, 18, 24, 30, 36, 42 or 48 hours). Once the required duration is shown on the display, the super freeze function will commence after five seconds' delay and the freezer will beep twice to confirm the setting.

To switch off the super freeze function before the selected duration is complete, touch and hold the super freeze function key (D) for approximately three seconds. The super freeze symbol on the display will switch off and the freezer will beep twice to confirm the setting.

**IMPORTANT** Do not use the super freeze function for more than 48 hours

### Door open alarm

The freezer is equipped with an alarm which will beep when the door has been open for 120 seconds. It will beep every two seconds until the door is closed. Press any key to switch off the beep if required.

Please note:

In the event of a power failure, the freezer temperature settings will be restored to the programmed levels when the power returns.



## Care and Cleaning

Always disconnect the appliance from the power before any cleaning or maintenance.

- The refrigerator should be cleaned using a solution of bicarbonate of soda and lukewarm water.
- Do not use abrasive products or detergents. After washing, rinse and dry thoroughly.
- Clean the shelves and balconies separately by hand using soap and water. Do not put them in the dishwasher.
- Once cleaning is complete, reconnect the mains power supply.
- If the appliance is not used for prolonged periods of time or in the event of a prolonged power cut unplug and clean the appliance. The doors should be left slightly open to prevent the formation of mildew and smell.
- The door seal should be cleaned periodically.
- Clean the control panel with a dry cloth.
- Fingerprints are easily left on the exterior of this appliance. Use a dry towel to clean them off.
- Periodically dust the back and underneath of the refrigerator.
- If food products come into contact with the refrigerator's exterior surface, we recommend that you clean them off immediately.
- When disposing of this appliance, remove the door seal to avoid accidental entrapment.

### Defrosting the freezer

The freezer is frost free and as such is designed not to require defrosting.

To switch off the compressor for a short period of time and so to force a defrost cycle, press and hold the increase and decrease keys for approximately three seconds. The freezer will beep and the display will show 3. When the force defrost cycle is complete, press and hold the increase and decrease keys for approximately three seconds. The freezer will beep and the display will show the previous freezer temperature.

## Troubleshooting

If you have any problems with your appliance, you should check the troubleshooting prior to calling CDA Customer Care to prevent unnecessary service calls and potential cost.

If the appliance is not working

- Check there is power to the appliance.
- The house fuses are intact and the fuse in the plug has not blown.
- The plug socket is functioning fine. To check this, plug another electrical appliance in to see if the socket is working.
- The temperature of the room is adequate (10°C or above).

If the appliance is working, but not very well

- The appliance is not overloaded.
- The thermostat is set to an appropriate temperature.
- The door is closing properly.
- The cooling system at the rear of the appliance is clean and free of dust, and not touching the rear wall.
- There is enough ventilation at the side and rear walls.
- The temperature of the room is adequate (10°C or above).
- Check that the appliance is set to an appropriate temperature.
- Check that the interior furniture has been arranged correctly.

If the appliance is noisy

- The appliance is level and stable.
- The side and rear walls are clear, and there is nothing resting on the appliance.
- The cooling gas in the refrigerator will make a slight bubbling noise, even when the compressor is not running.

Please note:

The LED lighting cannot be replaced without a service call. If the light fails, contact CDA Customer Care.

## Error Codes

The display will show error codes if there is a fault with the appliance. These are detailed below.

Before calling CDA Customer Care, take note of the error code as this will help when attempting to resolve the problem.

Error Code	Error Code
E2	Freezer temperature sensor failure
E5	Defrost sensor failure
E6	Communication failure
E7	Ambient temperature sensor failure
E9	High temperature warning
EC	PCB failure

## Installation and Ventilation

This appliance must never be installed close to heat sources i.e. heating elements, cookers or in damp places.

The diagram shows the ventilation requirements for your product.

Failure to provide adequate ventilation can lead to increased running costs and premature failure and may invalidate the warranty provided with the product.

- Ensure ventilation openings are kept clear.
- Do not use a multi-purpose socket alongside other appliances.
- Do not tilt the fridge beyond 45°
- Do not exert excessive pressure on the appliance.
- Place the refrigerator in a well-ventilated position, away from heat sources, damp and direct sunlight.
- Ensure that a gap of no less than 50mm is left above the appliance and that the gap around the outside is no less than 100mm to allow the door to open fully (fig. 3).
- If the appliance is to be installed enclosed between units, please ensure there is a 50mm gap above the appliance and a 100mm gap at the rear of the appliance to the ceiling or any furniture above (fig. 4).

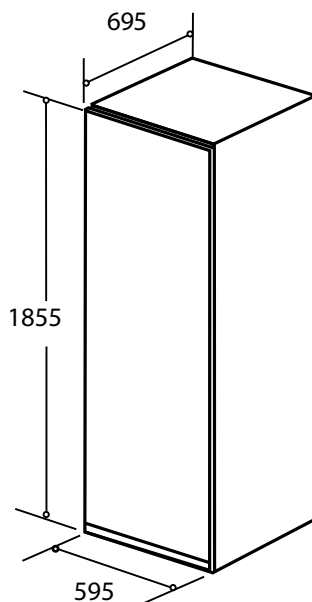


fig. 2

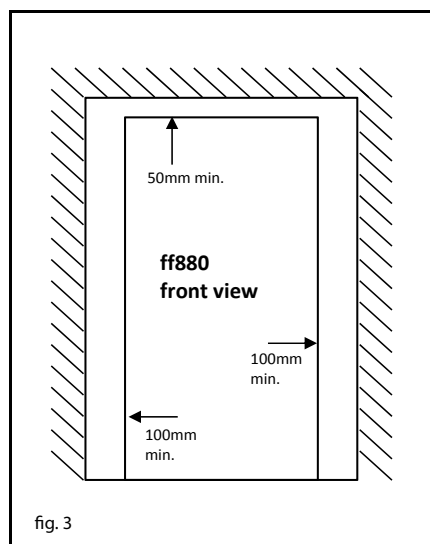


fig. 3

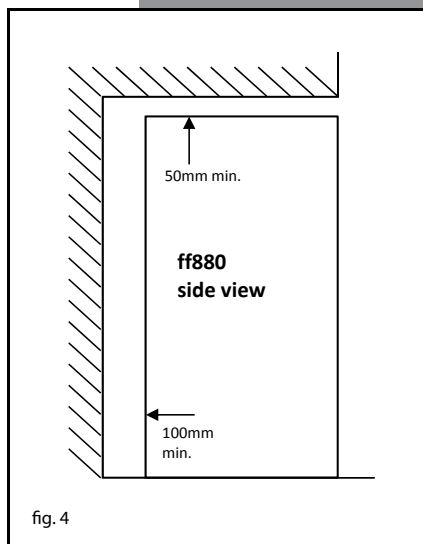


fig. 4



## Reversing the Door

We recommend you seek the help of another individual to support the doors whilst performing this operation.

1. Carefully remove the two hinge cover plates and two cover caps from the control panel.
2. Remove the control panel, ensuring that the wires are not damaged. We recommend you support the control panel with masking tape on the top of the freezer whilst it is detached.
3. Remove the screws securing the upper hinge whilst supporting the door. Lift the upper hinge and door away and place the door safely to prevent damage.
4. Remove the upper hinge from the door.
5. Remove the third hinge plate securing screw and relocate on the opposite side, leaving the screwhead approximately 3mm proud of the appliance.

fig. 5

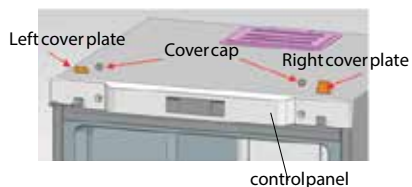
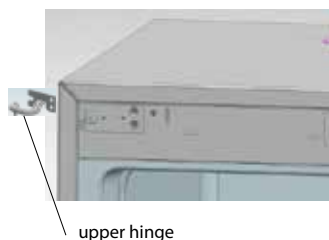
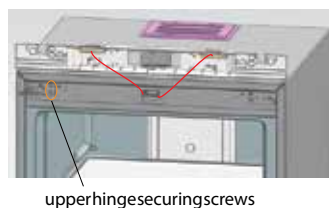


fig. 6



## Reversing the door

6. Remove the lower hinge and reposition the lower hinge pin as shown in figure 7.
7. Reposition the lower hinge on the opposite side as shown in fig 9.
8. Reverse the upper hinge pin as shown in fig 8.
9. Locate the door on the lower hinge pin, then locate the upper hinge pin in the door.
10. Slot the upper hinge into the locating screw on the appliance and then secure with the two screws removed in step 3.
11. Carefully refit the control panel, ensuring there are no trapped wires.
11. Replace the cover caps and hinge cover plates.

fig. 7

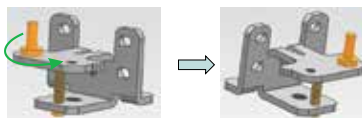


fig. 8

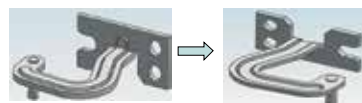


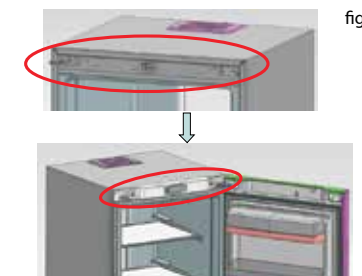
fig. 9



fig. 10

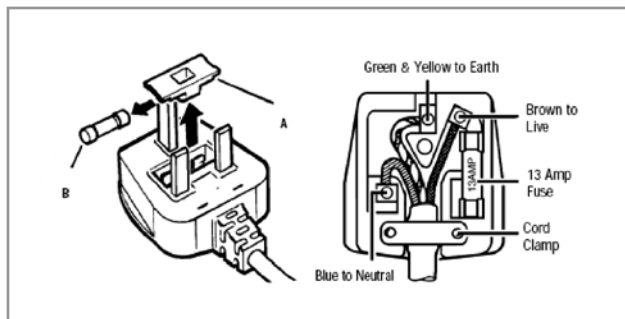


fig. 11



## Electrical information

Warning! This appliance must be earthed.



The mains lead of this appliance has been fitted with a BS 1363A 13 amp fused plug. To change a fuse in this type of plug, follow the steps below:

1. Remove the fuse cover and fuse.
2. Fit replacement 13A fuse, ASTA approved to BS 1362 type, into the fuse cover.
3. Replace fuse cover.

Important: Do not use the appliance without the fuse cover in position.

### How to connect an alternative plug

If the fitted plug is not suitable for your socket outlet, then it should be cut off and disposed of safely to avoid possible shock hazard. A suitable alternative plug of at least 13 Amp rating to BS 1363 should be used.

As the colours of the wires in the mains lead of this appliance may not correspond with the coloured markings identifying the terminals in your plug, proceed as follows:-

- The wire which is coloured GREEN and YELLOW must be connected to the terminal which is marked with the letter (E) or by the Earth symbol  $\text{—}\perp\text{—}$  or coloured GREEN and YELLOW.
- The wire which is coloured BLUE must be connected to the terminal which is marked with the letter (N), or coloured BLACK.
- The wire which is coloured BROWN must be connected to the terminal which is marked with the letter (L) or coloured RED.

If in doubt regarding the electrical connection of this appliance, consult a qualified electrician. Do not shorten the supply cable, the appliance may require removing for servicing.

N.B. Ensure that the plug socket is situated in an easily accessible place.

If the power supply cord is damaged, it must be replaced by a CDA authorised agent.



To contact our Customer Care Department, or for Service,  
please contact us on the details below.